

# Control Joint Replacement Top Instructions



## Necessary Tools

- Circular Saw ( $1/8''$  blade)

## Optional Tools

- Miter Saw
- High-Pressure Washer

## Coverage

Coverage: 200 lineal ft (60.96 m)

## Installation

1. Saw cut the existing control joint down to the middle with a  $1/8''$  wide blade. Kerf (must saw top and bridge.)
2. Set the saw to cut  $1/2''$  deep, so that the inside bridge is also cut.
3. Clean debris from along both sides of control joint. A high pressure washer works well.
4. The Control Joint Replacement Top can then be placed over the top and secured with PVC glue

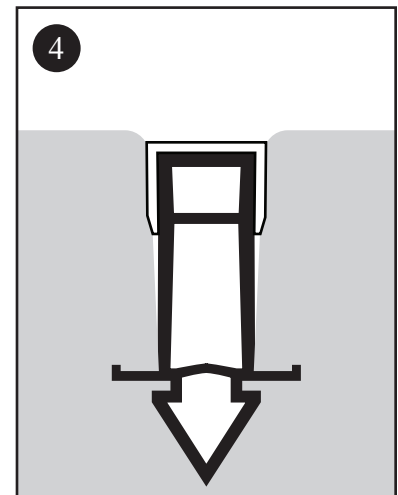
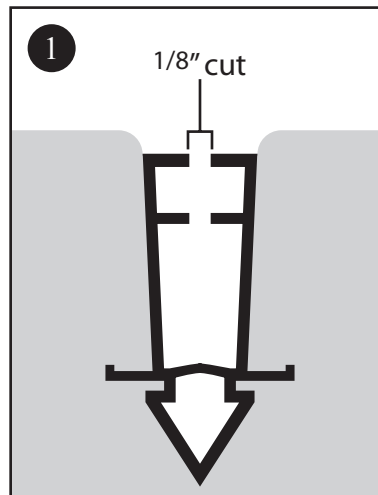
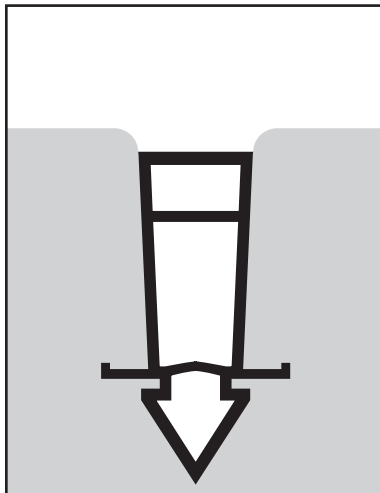

*The manufacturer offers this product and Information in good faith, but without guarantee either expressed or implied, as conditions and methods of use of our product are beyond our control.*